

SITE PLAN SHOWING OF L.U.C.C. OF 1. SRI AJIT KUMAR SINGH/S/O SRI RAM SAKHA SINGH & 2. SMT. SEEMA DEVI SINGH, W/O SRI AJIT KUMAR SINGH AT JYOTINAGAR COLONY, CHAMPASARI, P.O. + P.S. - PRADHAN NAGAR, SILIGURI WARD NO. - 46 (S.M.C.), DIST. - DARJEELING

AREA SCHEDULE:-  
 1351.65 Sq. Mt. (AS PER DEED)  
 1351.65 Sq. Mt. (AS PER SITE)

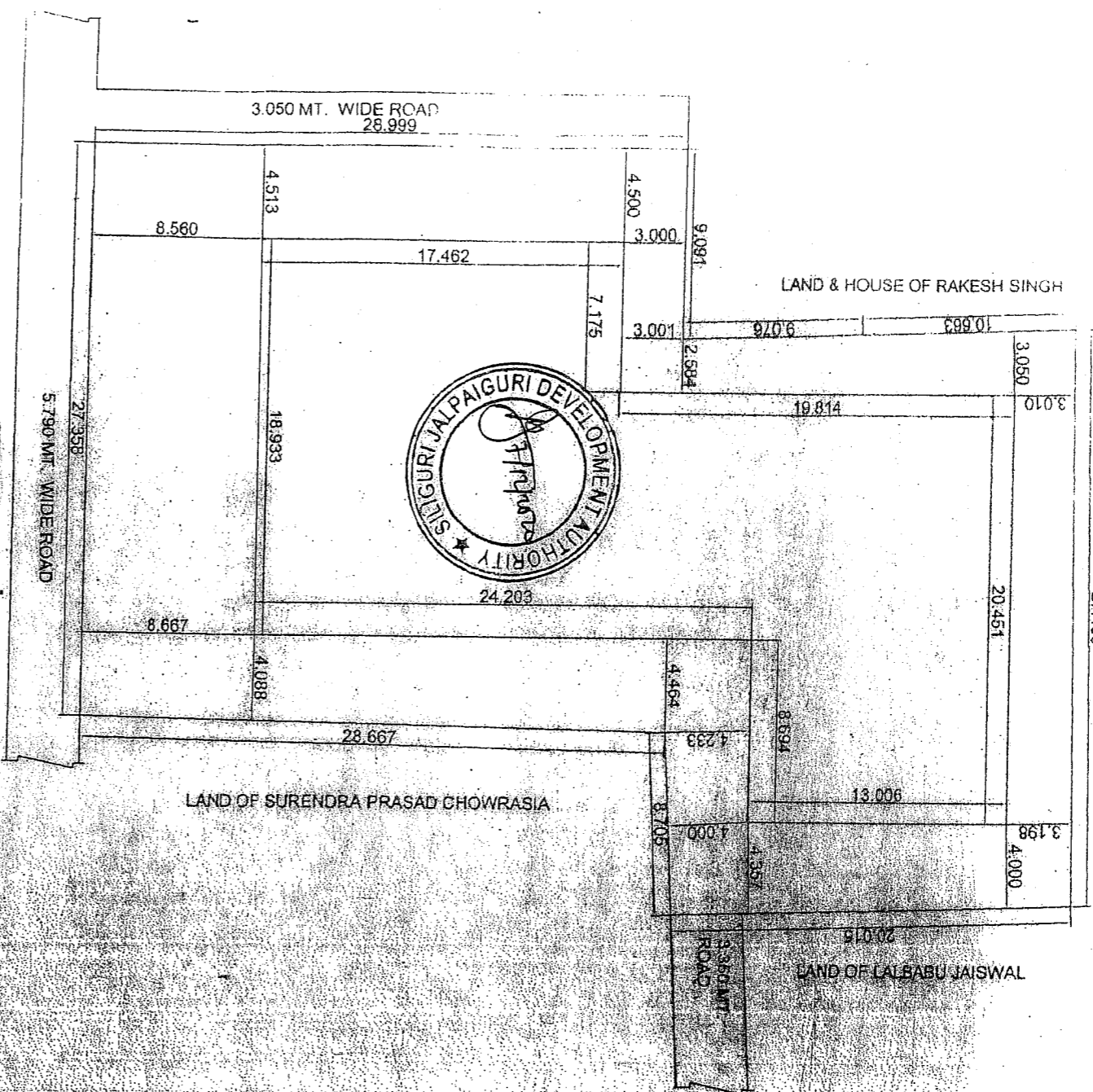

LAND OF LALAN PRASAD GUPTA AND BABAN GUPTA  
 27.499



NOTE :- ALL DIMENSIONS ARE IN METERS  
 SCALE - (1:1000) AS PER DEED  
 (1:1) IN DRAWING

**LAND SCHEDULE:-**

MOUZA - MANDLAGURI  
 SHEET No. - 01 (R.S.)  
 PLOT No. - 88, 89 & 92 (R.S.)  
 8245, 8246 & 8147 (L.R.)  
 WARD No. - 46 (S.M.C.)  
 P.S. - PRADHAN NAGAR  
 DIST. - DARJEELING  
 KHATAN NO. - 62/1 & 62/3 (R.S.)  
 724 & 735 (L.R.)

**LOCATION PLAN**  
 SCALE - N.T.S.

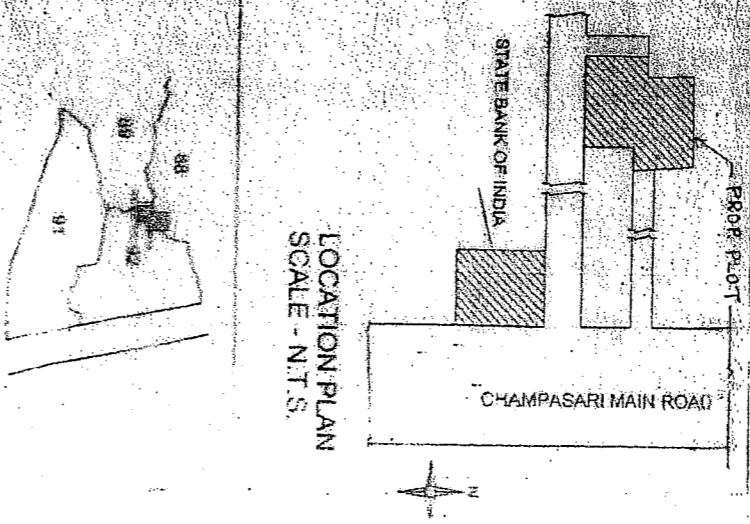

PART TRACE OF MOUZA MAP  
 MOUZA - MANDLAGURI  
 SHEET No. - 01  
 SCALE - N.T.S.



**MARGIN DETAIL:**

Building / Wing Name	Road Name	Front Margin	Ground Work Front Margin	Rear Margin	Ground Work Rear Margin	Side Margin	Ground Pw
PROPOSED BUILDING	5.790 MT WIDE ROAD	8.56	8.56	8.01	8.01	2.58	